

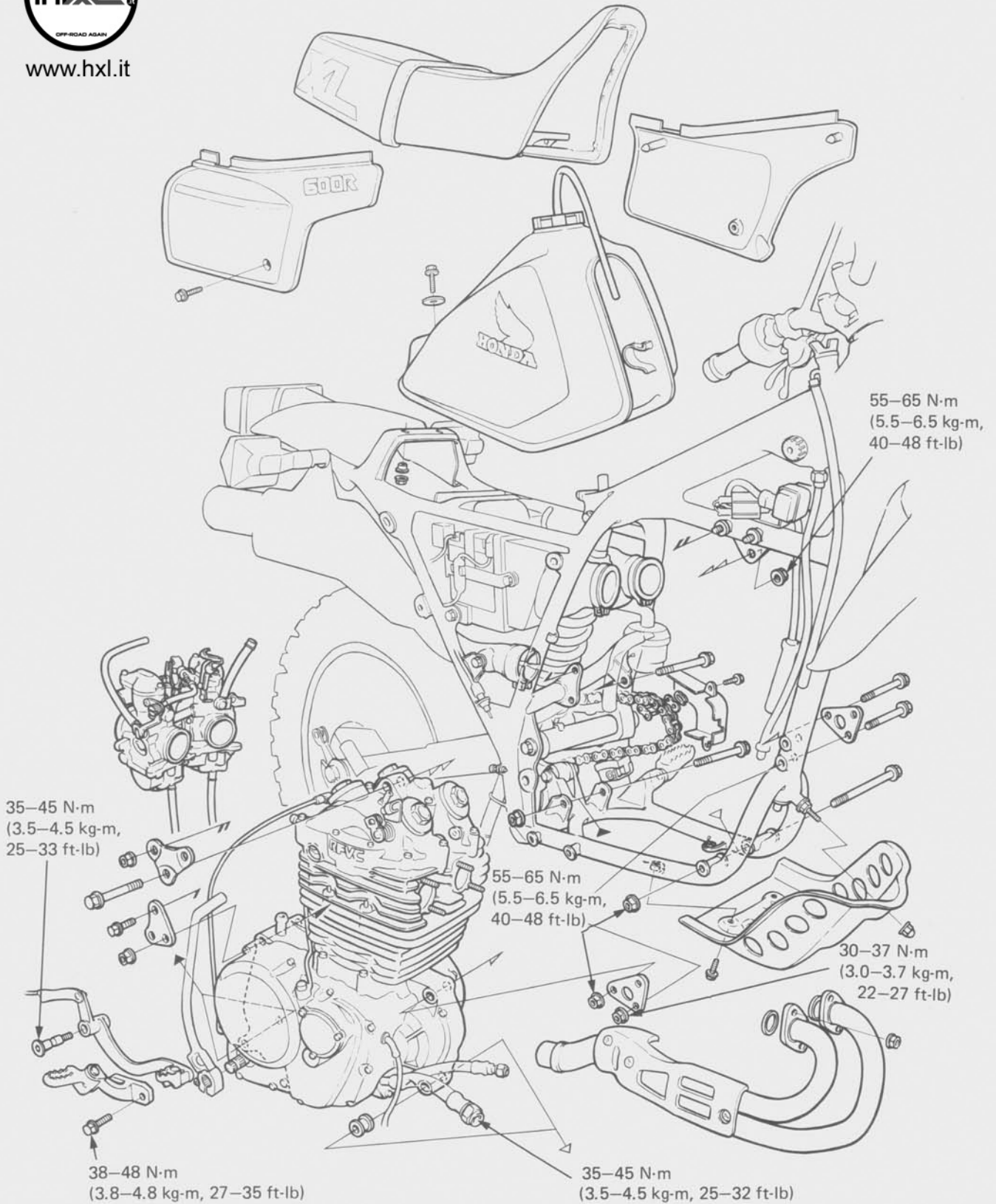

www.hxl.it





SERVICE INFORMATION	5-1
ENGINE REMOVAL	5-2
ENGINE INSTALLATION	5-6

## SERVICE INFORMATION

### GENERAL INSTRUCTIONS

- During removal and installation, support the vehicle with a suitable box or workstand.
- A jack or adjustable support is required to maneuver the engine.
- Parts requiring engine removal for servicing:
 

Cylinder head	Section 6
Cylinder	Section 7
Crankshaft	Section 11
Balancer	Section 11
Transmission	Section 12

### SPECIFICATIONS

Engine weight	44 kg (97 ft-lb)
Oil capacity	2.5 lit (2.6 US qt, 2.2 Imp qt) after disassembly 2.0 lit (2.1 US qt, 1.8 Imp qt) after draining

### TORQUE VALUES

Engine hanger bolts:	
8 mm bolt	30-37 N·m (3.0-3.7 kg-m, 22-27 ft-lb)
10 mm bolt	55-65 N·m (5.5-6.5 kg-m, 40-47 ft-lb)
Foot peg bolt	38-48 N·m (3.8-4.8 kg-m, 27-35 ft-lb)
Muffler band	15-25 N·m (1.5-2.5 kg-m, 11-18 ft-lb)
Exhaust manifold nut	18-25 N·m (1.8-2.5 kg-m, 13-18 ft-lb)
Oil pipe flear nuts	35-45 N·m (3.5-4.5 kg-m, 25-32 ft-lb)
Exhaust pipe protector	8-12 N·m (0.8-1.2 kg-m, 6-9 ft-lb)
Rear axle nut	80-100 N·m (8.0-10 kg-m, 58-72 ft-lb)
Seat	8-12 N·m (0.8-1.2 kg-m, 6-9 ft-lb)



## ENGINE REMOVAL

Drain the oil from the engine and down tube.  
Remove the seat.  
Turn the fuel valve "OFF" and disconnect the fuel lines. Remove the fuel tank.



Disconnect the alternator and pulse generator wire.  
Remove the spark plug cap.

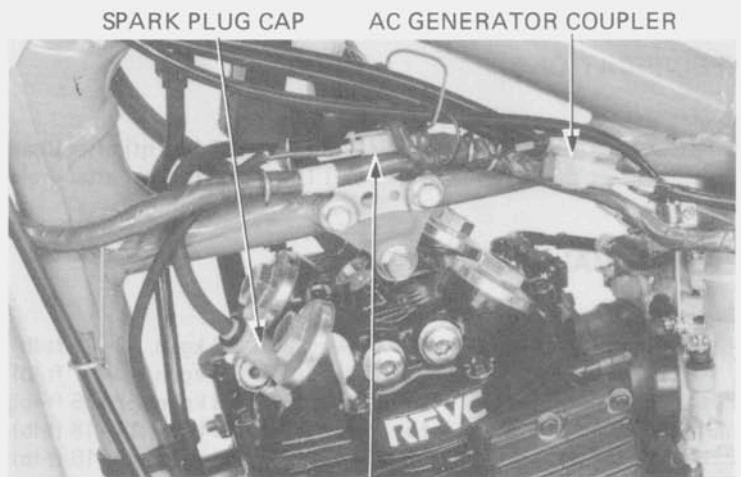

Remove the right foot peg.  
Remove the rear brake linkage and rear brake pedal.  
Disconnect the kick starter decompressor cable.

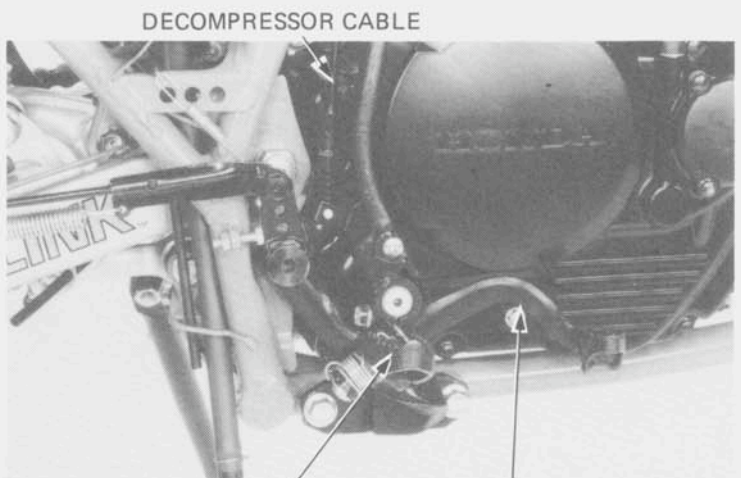



Disconnect the separator tubes and remove the separator.

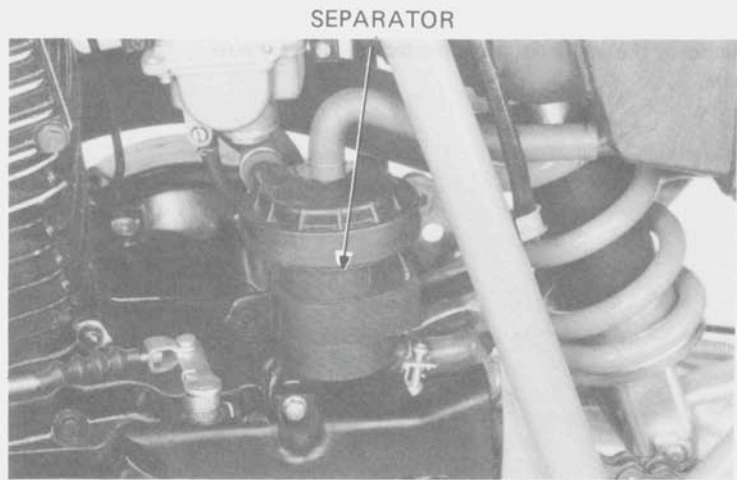

Remove the left foot peg.  
Loosen the rear axle nut.  
Turn the chain adjuster to loosen the chain.  
Remove the drive sprocket cover.

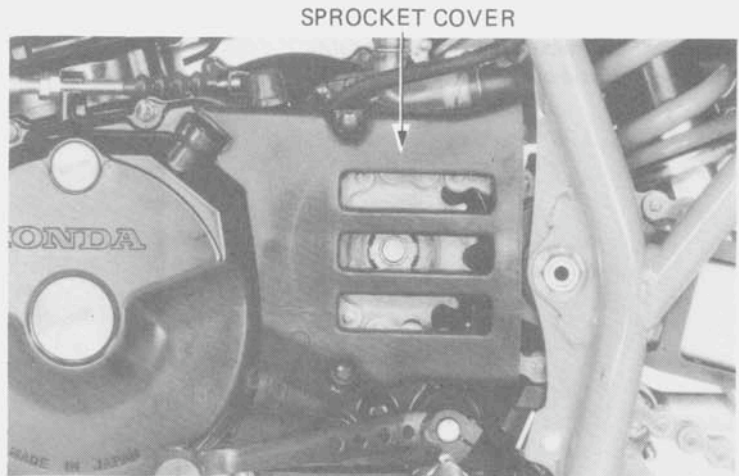

Disconnect the drive chain from sprocket.  
Remove the clutch cable.

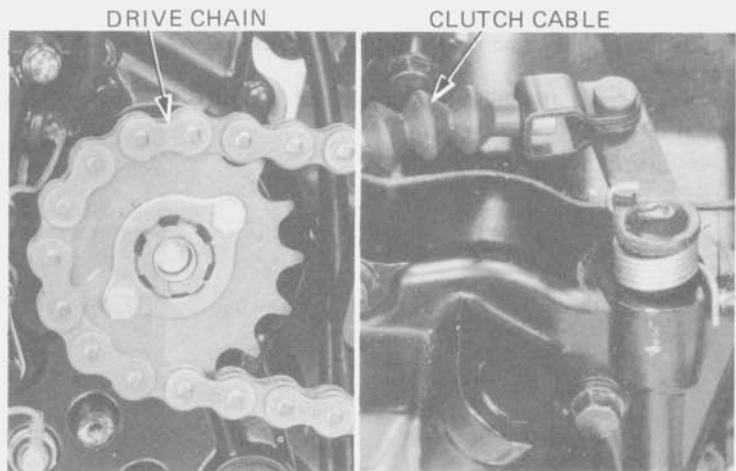



**ENGINE REMOVAL/INSTALLATION**

Remove the exhaust pipe protector and exhaust pipe.



Disconnect the manual decompressor cable.  
Disconnect the oil over flow tube.

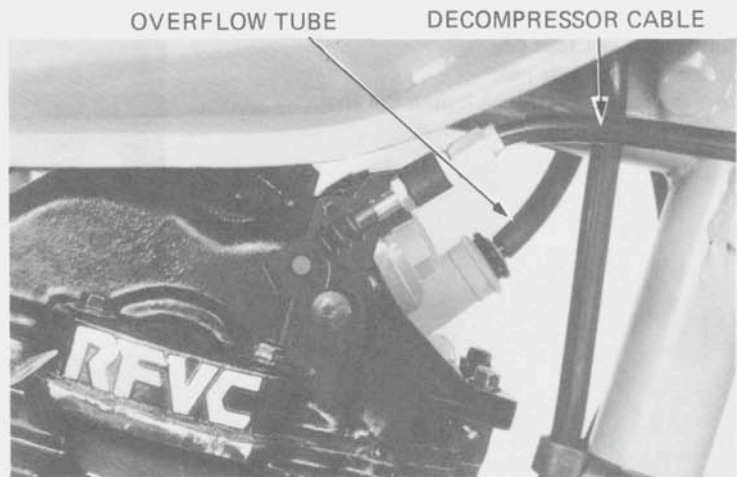

Loosen the oil inlet and outlet hose joint nuts and disconnect.  
The hoses from the oil outlet pipe and the oil strainer nut.

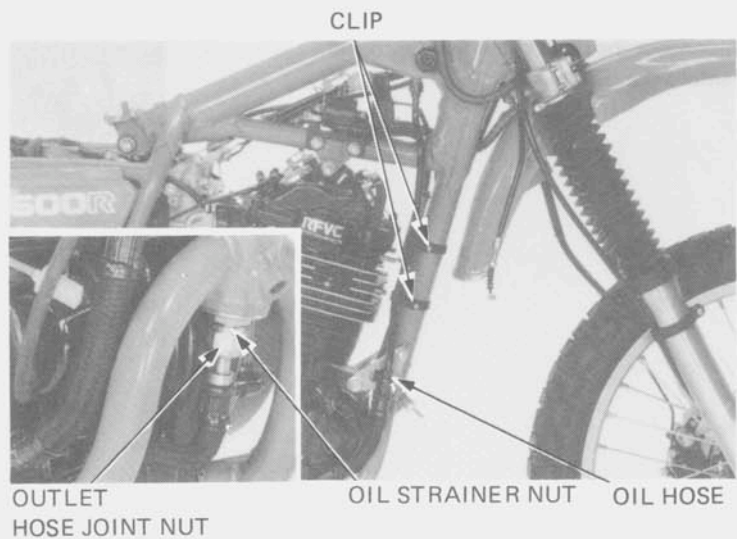



Remove the three bolts on the carburetor insulator. Loosen the carburetor bands, then remove the carburetors.

Place a jack or padded block under the engine. Remove the upper engine hanger bracket. Remove the front engine hanger bracket and bolt. Remove the rear engine hanger bracket and bolts. Remove the engine.

**NOTE**

Jack height must be continuously adjusted during engine removal and installation to prevent damage to mounting bolt threads, wire harnesses and cables.

**CARBURETOR BAND**

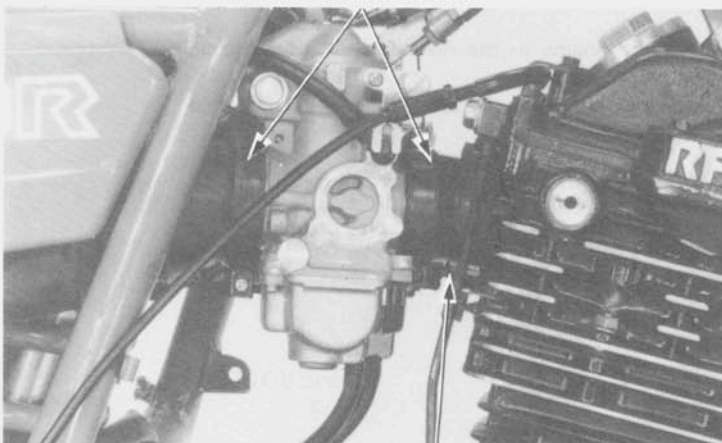

**CARBURETOR INSULATOR**



## ENGINE INSTALLATION

Install the engine in the reverse order of removal, noting the following:

Replace any damaged or leaking exhaust pipe gaskets.

Tighten all bolts to the proper torque specifications.

Route all wire harnesses and cables properly (Page 1-8 and 1-9).

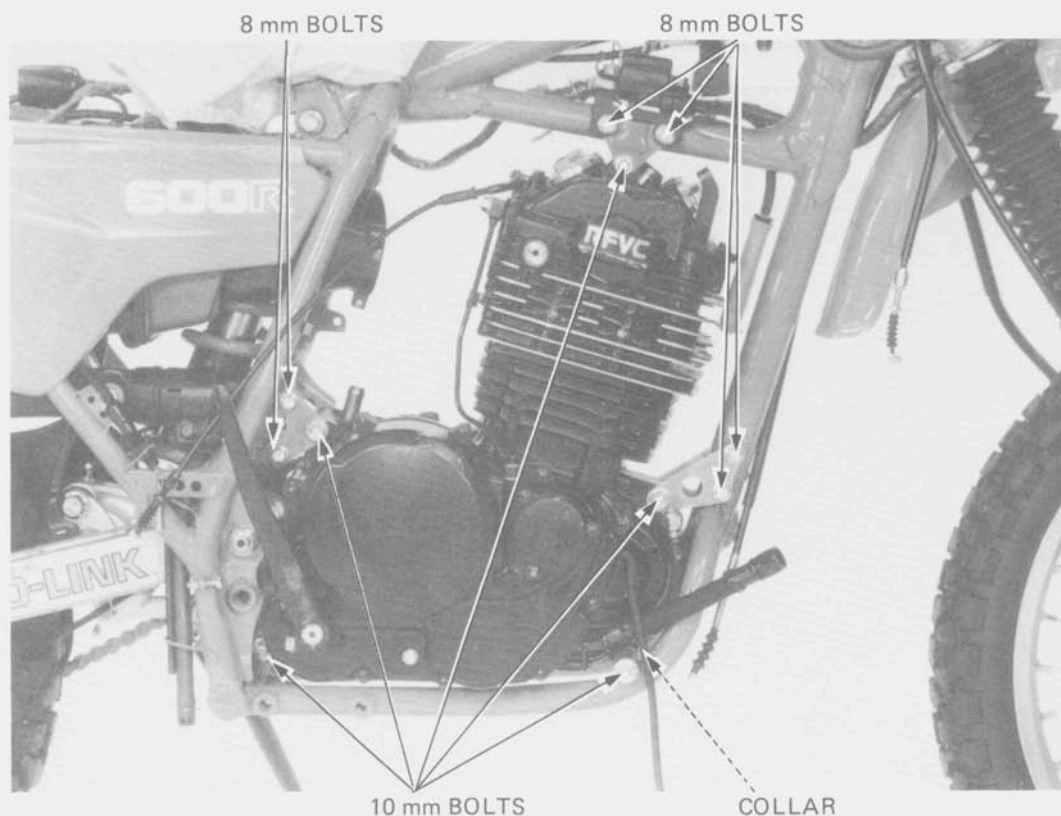

Perform the following inspections and adjustments:

- Engine oil (Page 2-2).
- Throttle grip free play (Page 3-3).
- Drive chain (Page 3-11).
- Rear brake pedal free play (Page 3-14).
- Clutch lever free play (Page 3-16).
- Decompressor lever free play (Page 3-8).
- Check all electrical equipment.



**HONDA**  
**XL600R**

ENGINE REMOVAL/INSTALLATION

---

MEMO